

**Highways Act 1980 Section 119
Wildlife and Countryside Act 1981 Section 53A**

**Diversion of Footpaths
Bacup 415 and 416 and part of 417 and Creation
of a Public Footpath at Greave Clough**

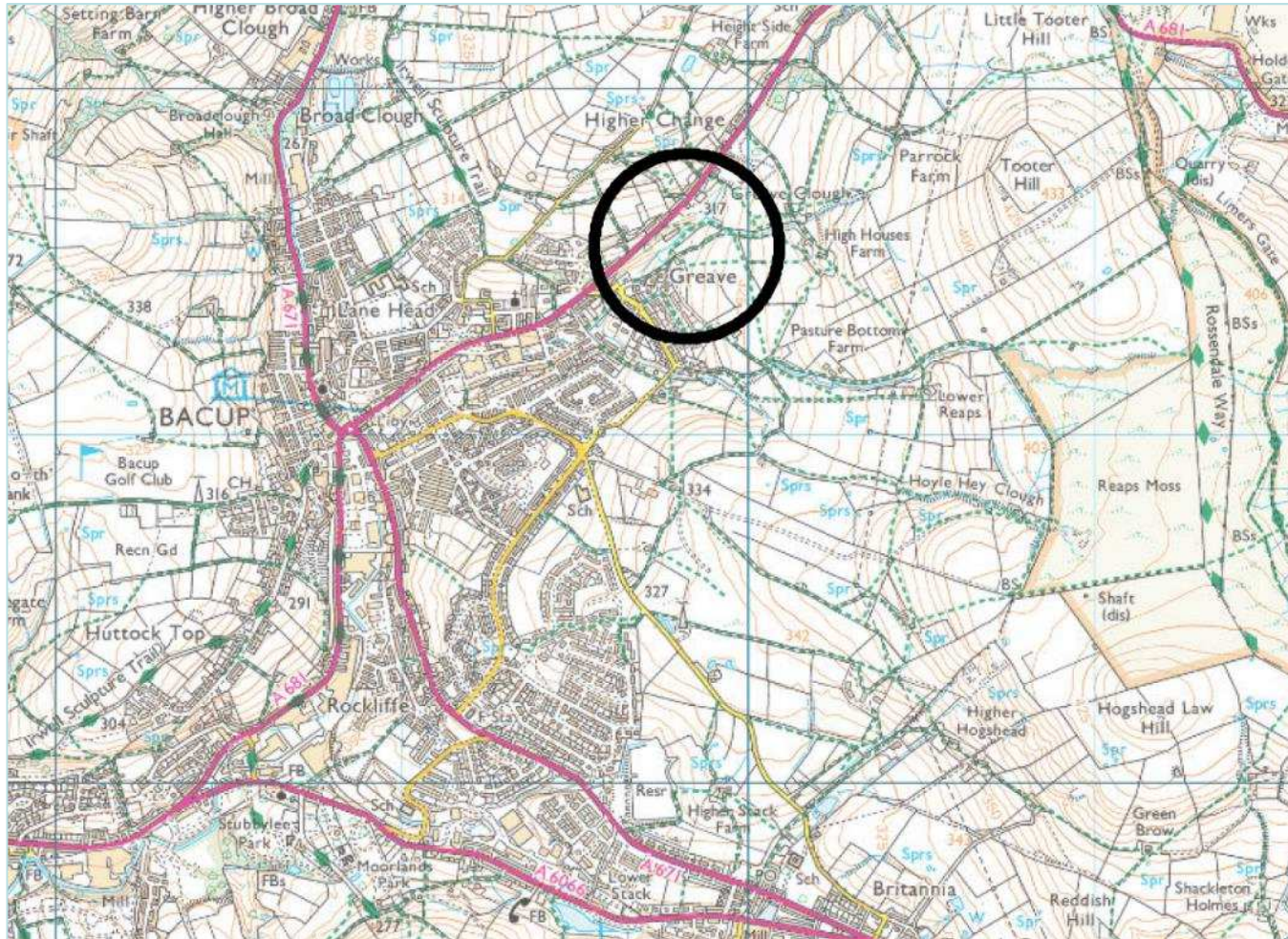

This Map is reproduced from the 1:24,000 Ordnance Survey material with the permission of Ordnance Survey on behalf of the controller of Her Majesty's Stationery Office (C) Crown Copyright. Unauthorised reproduction infringes Crown Copyright and may lead to Prosecution or civil proceedings. Lancashire County Council Licence No. 100023320

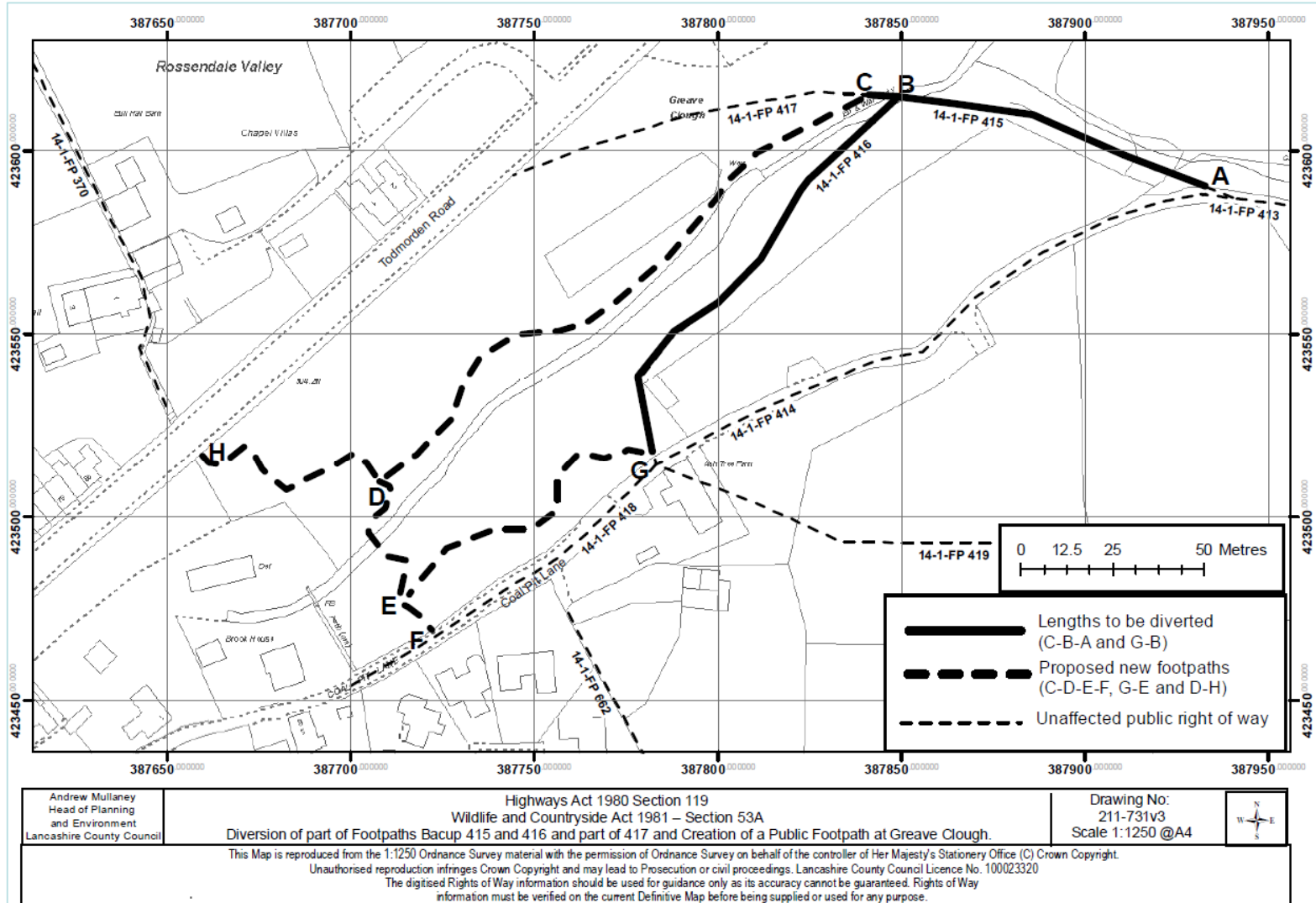

Footpath to be diverted

C-B-A

Junction of Footpaths Bacup 415, 416 and 417 at point B

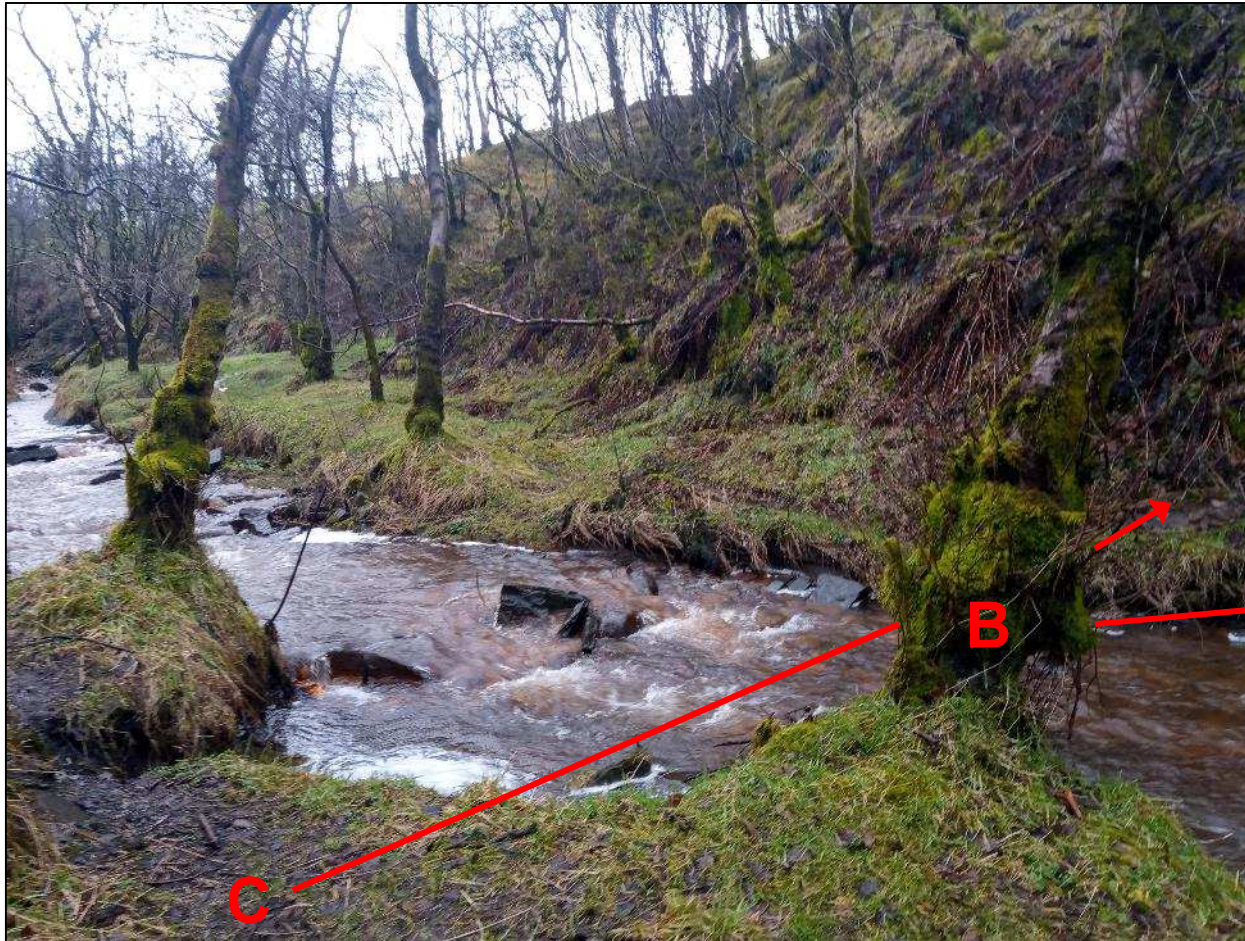

**From the top of the slope,
looking back at points B and C**

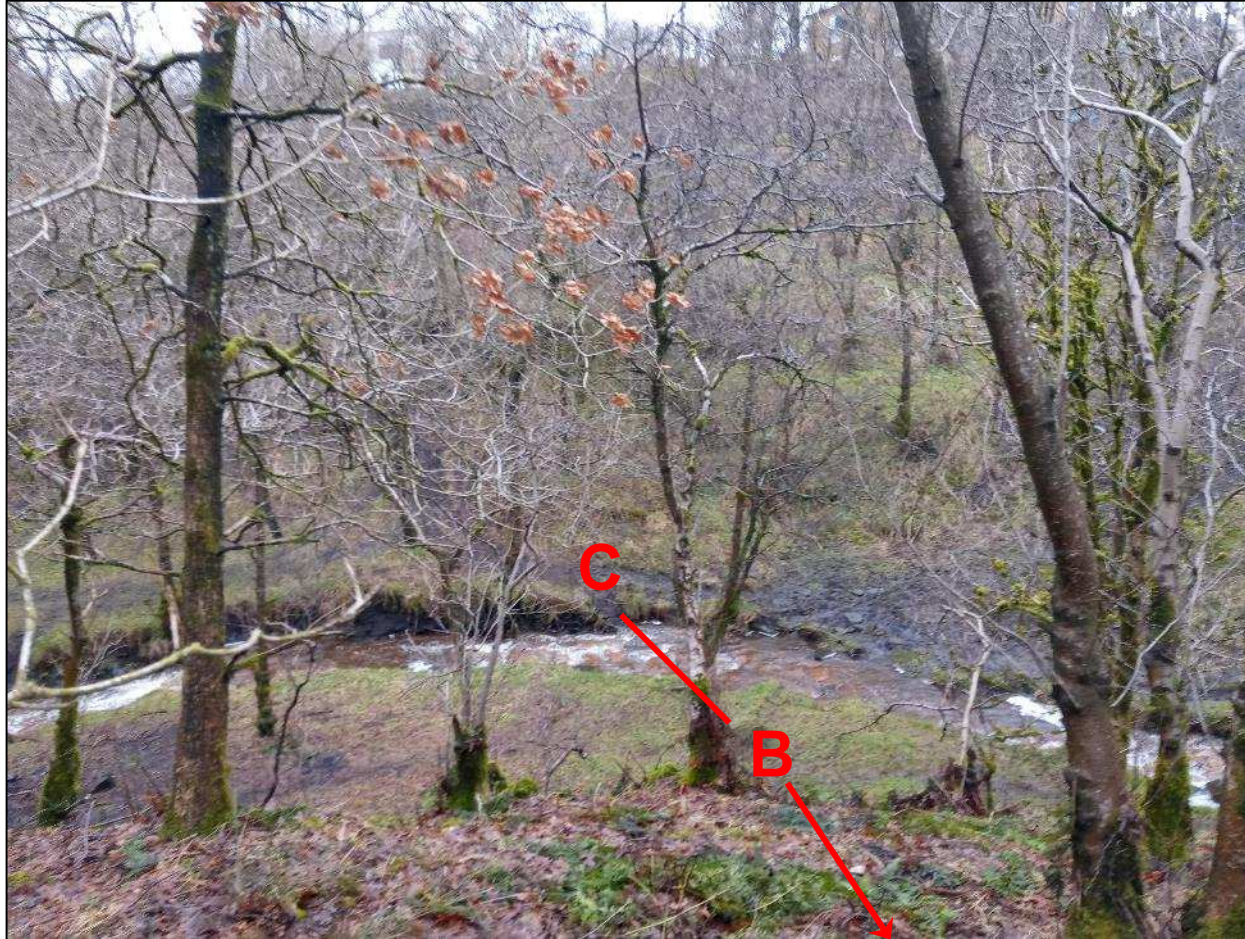

Continuing towards point A, looking back in the direction of points B and C

7



Continuing towards point A



Continuing towards point A



Point A at junction of Footpaths Bacup 413, 414 and 415



Proposed new route C-D-E-F

From point C, looking in the direction of point D



Continuing towards point D



Continuing towards point D



Continuing towards point D



Reverse view, looking back in the direction of point C



Continuing towards point D



Point D



Continuing towards point E



Continuing towards point E



Looking south west from the footbridge



Looking north east from the footbridge



Continuing towards point E



Point E, continuing towards point F

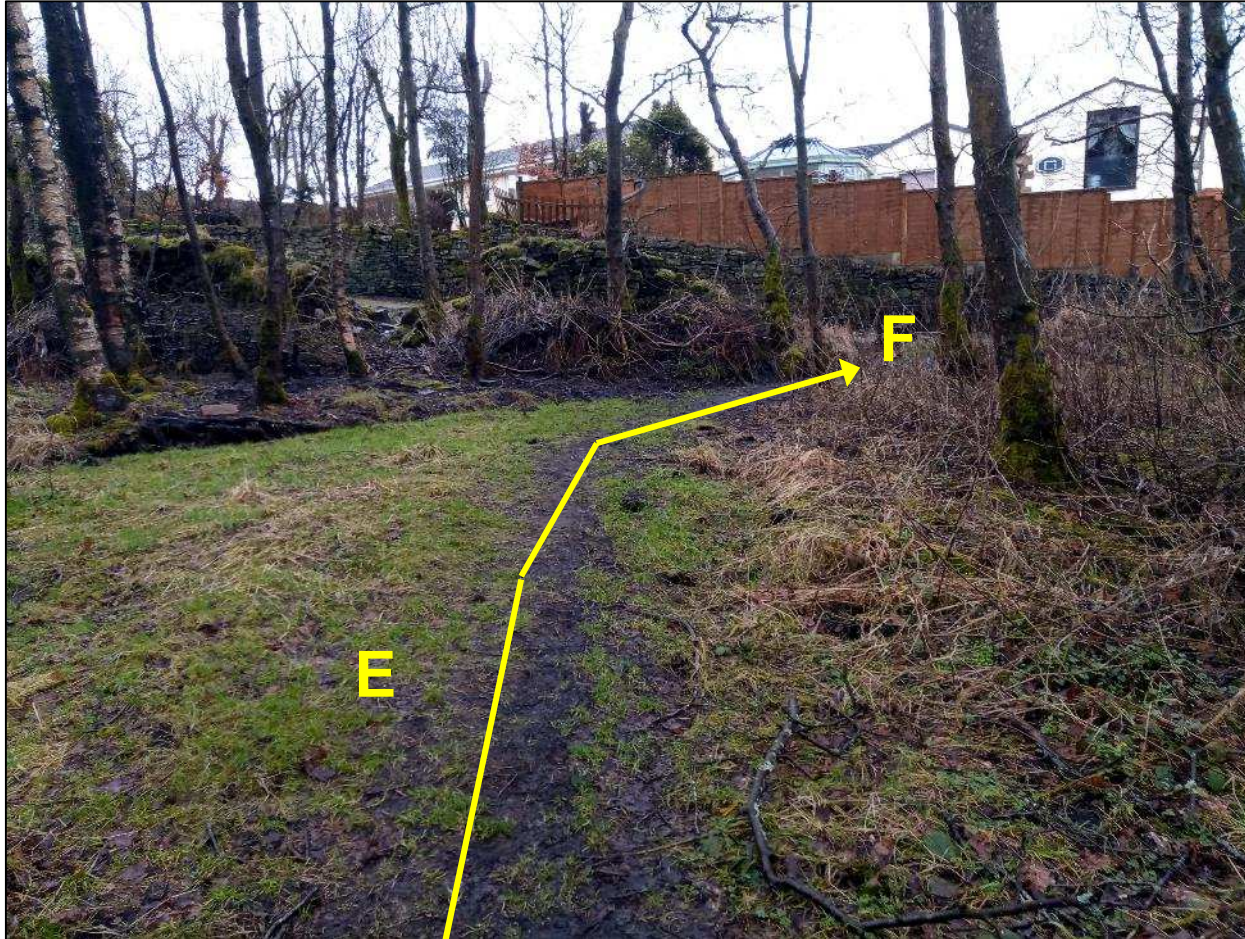

Junction with Footpath Bacup 418 (Coal Pit Lane) at point F



Footpath to be diverted

G-B

Junction of Footpaths Bacup 416 and 418 (Coal Pit Lane) at point G



From point G, looking in the direction of point B



Continuing towards point B



Continuing towards point B



From the top of the slope, looking down towards points B and C

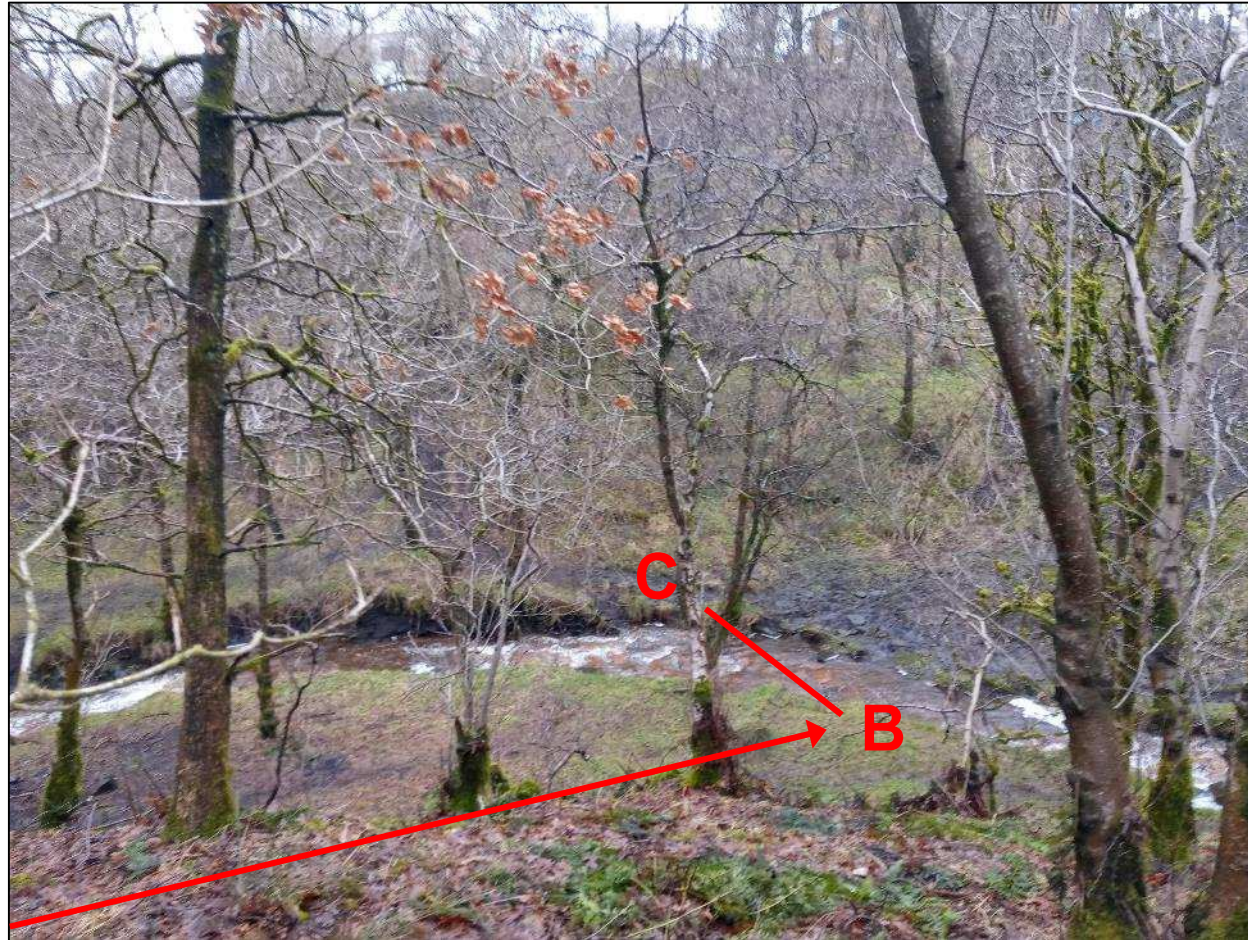

Proposed new route G-E

Junction of Footpaths Bacup 416 and 418 (Coal Pit Lane) at point G



Continuing towards point E



Continuing towards point E



Point E



Proposed new route H-D

Point H at junction with Todmorden Road



Continuing towards point D



Continuing towards point D



Point D



